

PARIS XV^e

SOCIÉTÉ ANONYME ANDRÉ CITROËN, 117 A 167, QUAI ANDRÉ-CITROËN

CITROËN

INSTRUCTION BOOK

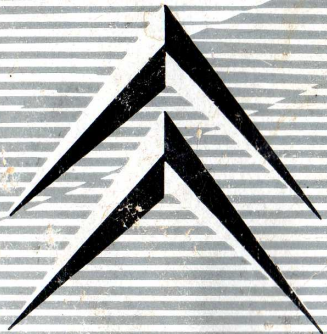

Station-Wagon



OWNER'S MANUAL

for the

ID 19

STATION-WAGON

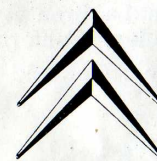

HEAD OFFICE :

SOCIÉTÉ ANONYME ANDRÉ CITROËN
PARIS

Service and Parts :

CITROËN CARS CORPORATION.
20 West End Avenue.
New York 23, N. Y.
Telephone : Judson 2-5920.

General Office :

CITROËN CARS CORPORATION.
121 West 50th Street,
New York 20, N. Y.
Telephone : PLaza 7-2212.

Service and Parts :

CITROËN CARS CORPORATION.
960 North La Brea Avenue,
Los Angeles, California.
Telephone : OLdfield 6-6610.

General Office :

CITROËN CARS CORPORATION.
8423 Wilshire Boulevard,
Beverly Hills, California.
Telephone : OLive 3-8330.

ALPHABETICAL INDEX

	Page No.		Page No.
Air filter.....	18	Interior lights.....	28
Antifreeze	18	Level, battery	18
Battery	17	— engine oil.....	6
Brakes.....	9, 10 & 19	— gearbox.....	34
Carburetor	17	— hydraulic fluid.....	6 & 7
Characteristics	37	— water	6
Choke	7	Lighting (headlights).....	12
Comfort	27	Log book	(in fine)
Dashboard	11 & 12	Lubrication	33
Defroster-demister.....	12 & 27	Maintenance	17
Doors	29	Mileage recorder.....	11
Driving	5	Oil	33
Draining, engine sump.....	34	Oil dipstick.....	6
Draining, gearbox	36	Overhaul after 300 miles.....	2
Fuses	24	Precautions against frost.....	18
Fuel filter	18	Roof Rack	32
Fuel level gauge	11	Running-in	4
Gear shift	9	Seat adjustment.....	29
Greasers	36	Settings	38
Greasing record.....	(in fine)	Spark plug replacement.....	22
Ground clearance adjustment...	13	Starting	7
Guarantee	2	Tires (pressure).....	26
Headlights (adjustment)	22	Upholstery	25
Heating	27	Ventilation	12 & 27
Hood (locking).....	5	Water	6
Horns	12	Wheels and hubs.....	19
Hydraulic fluid filter.....	19	Wheel changing.....	14 to 16
Ignition timing.....	12	Windshield washer.....	13 & 32
		Windshield wipers.....	12

FOREWORD

Upon delivery of your car your Authorized Citroën dealer will give you a Guarantee Card. After the first 300 miles your car must receive a checkup which is performed free of charge by your authorized Dealer. The guarantee card must be presented to obtain this free Service. After completion of the operation listed below, your dealer will fill in the guarantee card and retain one part and forward it to the Factory or Factory branch and the other part is to be retained by the Owner.

NOTE : The terms of the guarantee will be voided if the 300 mile checkup has not been performed in due time, or if the customer cannot produce the guarantee card duly filled in.

35 operations of the " 300 mile checkup "

1. Check tire pressure.
2. Check tightening of bolts fixing the wheels.
3. Tighten cylinder head.
4. Adjust tappets.
5. Tighten connectors of valve rocker lubrication pipes.
6. Tighten exhaust pipe.

7. Tighten nuts fixing intake manifold and carburetor.
8. Check tension of fan belt and generator belt.
9. Clean hydraulic filter.
10. Check adjustment of clutch control.
11. Check operation of hand brake.
12. Start engine and let it run about 10 minutes.
13. Check hydraulic circuit for leakage.
14. Check level of hydraulic fluid and add fluid if necessary.
15. Adjust idling.
16. Check building of pressure in the accumulator and operation of pressure regulator.
17. Check oil level in transmission.
18. Check height adjustment.
19. Drain crank case and refill with proper grade oil.
20. Lubricate drive shafts and upper knuckles.
21. Adjust rear brakes.
22. Check water level in battery, tighten terminals.
23. Check tightening of terminals of starter, starter relay, and voltage regulator.
24. Check operation of head lamps and their adjustment.
25. Check operation of windshield wipers, interior light, tail lights and stop lights, directional signals, horn, battery charge indicator and instrument panel lighting.
26. Check operation of doors.
27. Check operation of windows.
28. Check fastening of bumpers.
29. Check locking of hood.
30. Check operation of variable height adjustment control.
31. Check operation of windshield washer.
32. Check operation of seat controls.
33. Check operation of tail gate.
34. Check output of generator.

RUNNING-IN

During the first 300 miles, do not exceed the following speeds :

- 12 m.p.h. in first gear,
- 28 m.p.h. in second gear,
- 44 m.p.h. in third gear,
- 62 m.p.h. in fourth gear.

Do not race the engine until you reach 1,250 miles.

After 1,260 miles the car may be driven freely up to the following speeds :

- 25 m.p.h. in first gear,
- 50 m.p.h. in second gear,
- 71 m.p.h. in third gear.

The most economical driving speeds are as follows :

- 34 m.p.h. in second gear,
- 50 m.p.h. in third gear,
- 68 m.p.h. in fourth gear.

At no time drive the car in fourth gear below 40 m.p.h.

DRIVING

Checks before starting.

To open the hood :

- Release the right and left hood safety catches by passing both hands through the opening in the bumper on each side of the license plate and pull handles **1** and **2** (fig. 1).

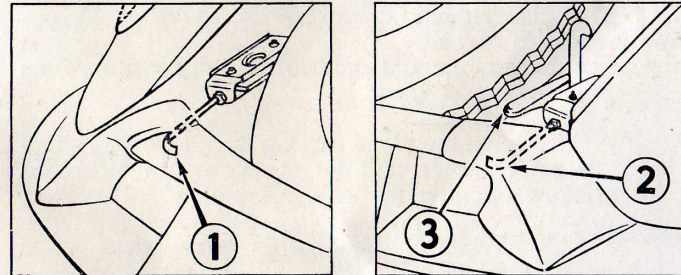

Figure 1

- Lift the hood slightly with your left hand and release it completely by passing your right hand between the hood and the bumper, on the right-hand side of the license plate, then press lever **3** (fig. 1).

To hold the hood open engage the end of the support (fig. 2) in the bracket on the left of the radiator above the exhaust pipe.

Engine oil : the dipstick is located on the left hand side of the engine behind the fuel pump and below the carburetor. The oil should be level with, but never over, the upper shoulder (the space between the lower 2 and the upper 1 marks corresponds approximately to 1-3/4 pints) (fig. 2 bis).

Water : The level should be approximately 1 inch from the top edge of the filling neck. If you want to check the water level with the engine running, remove the cap carefully,

as there is a slight pressure in the radiator when the engine is warm.

First give the cap a quarter turn to bring it into its safety notch and let the pressure decrease before opening the cap completely.

When the engine is **very warm**, it is safer to allow it to cool off first.

Hydraulic suspension fluid : The level of the fluid in the reservoir located to the left of the radiator and in front of the battery should be between the minimum and maximum marks on the transparent gauge (fig. 3). To read the level correctly, start the engine, set the height control in the

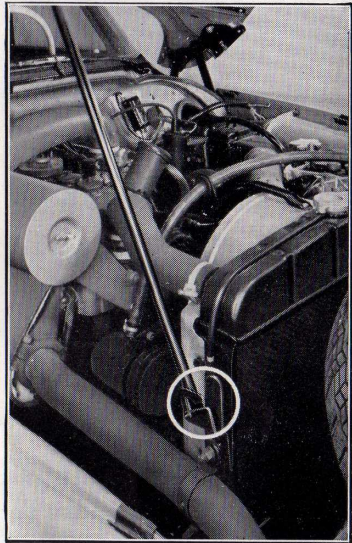

Figure 2
Keeping the hood open

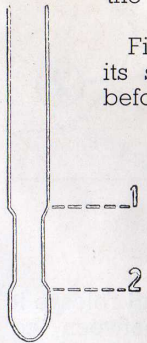

Figure 2 bis



Figure 3
Filter for hydraulic fluid

or oils for hydraulic jacks, shock absorbers, or automatic gear boxes in the hydraulic system. Use of these fluids will destroy the hydraulic system of your car completely and rapidly.

high position. Wait while the car becomes stabilized, then check that the level is within the Maxi and Mini marks.

To top up the level, if necessary, use only the type of hydraulic fluid recommended by your Citroën dealer.

If it is absolutely impossible to obtain the recommended brand of hydraulic fluid — you can use heavy duty brake fluid for automobiles.

VERY IMPORTANT : Never use any other liquid, particularly mineral based products, such as engine oils

Starting.

Make sure that the gear shift **5** (fig. 4) is in neutral. Turn on the ignition (switch **2**, fig. 4).

When the engine is cold : Pull out the choke knob **3** (fig. 4) completely and press the starter button **4** (fig. 4) without touching the accelerator pedal. If the engine does not start at the first attempt, wait three to five seconds, then repeat the operation.

As soon as the engine has started, progressively push back the choke until you feel an intermediate notch. Leave it in this position until the engine idles smoothly, then push

